

# COMPLETE SOLUTION FOR BIOSOLIDS SAMPLE PACKING.

PhoenixNMR now offers BioSolids sample spacers and centrifuge sample packing tools for 1.6mm and 3.2mm rotor sizes. These tools along with the molded silicone spacers make it easy to efficiently transfer your pelleted sample from 200  $\mu$ L ultracentrifuge tubes into a ready to use rotor that will keep your sample hydrated. If you are interested in spacers and tools for a different rotor size, we would be happy to consider your request.

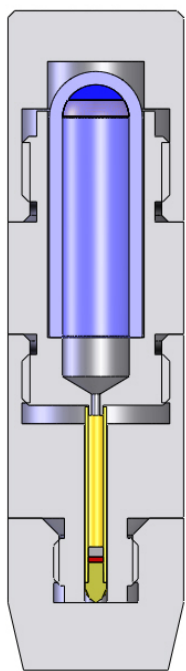

Section view of the rotor and 200  $\mu$ L ultracentrifuge tube loaded into the centrifuge sample packing tool and balance piece, ready for centrifuge packing.

- █ Light blue is the ultracentrifuge tube
- █ Dark Blue is sample
- █ Light Purple on top of sample is supernatant

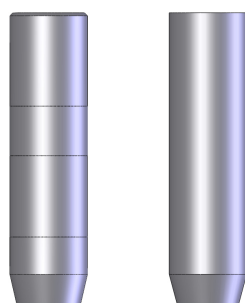

Centrifuge sample packing tool and balance piece



Centrifuge sample packing tool and balance piece shown inside of 15mL conical centrifuge tube

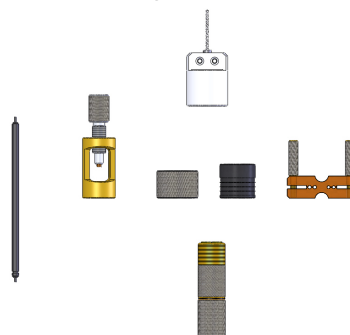

Standard sample packing tool kit with BioSolids spacer set tool



1.6mm rotor with molded silicone spacers installed maintains sample hydration



Packed rotor with end cap installed



Packed rotor spinning showing supernatant column in center

## Solids and BioSolids Sample Accessories:

	1.6mm	3.2mm (22µL)	3.2mm (36µL)	4.0mm
BioSolids Sample Spacer Kit (10 discs, 10 spacers, 5 top caps, Set Tool)	✓	✓	✓	ASK
BioSolids Packing Tools w/o Solids Tools (Spacer Kit, Centrifuge Tool, Balance)	✓	✓	✓	ASK
BioSolids Packing Tools (Includes Tools and Spacer Kit)	✓	✓	✓	ASK
Solids Test Sample Kits	✓	✓	—	✓
Deuterium Rotor	✓	✓	—	✓
Proton Shimming Rotor	✓	✓	—	✓

## Solids Test Sample Kits

PhoenixNMR is offering sample kits in 1.6, 3.2, and 4mm narrow bore rotor sizes. These sample kits work with all PhoenixNMR probes as well as Varian/Agilent narrow bore probes. Calibrate pulse widths, set magic angle, measure sensitivity, and check lineshape. They are a great way to validate your system and can be used in troubleshooting whether there is a system issue, a problem with a sample, or the probe. If your probe has a deuterium lock channel, we have a D<sub>2</sub>O rotor utilizing our BioSolids sample spacers. An additional rotor is available to initially shim on Proton that aids in final lineshape on <sup>13</sup>C. Looking for a different size than what is listed? Ask us, and we can discuss your needs.

### Test Samples

- Potassium Bromide - Magic Angle
- Adamantane - <sup>1</sup>H, <sup>13</sup>C pw90 and <sup>13</sup>C lineshape
- <sup>15</sup>N labeled Glycine - <sup>15</sup>N pw90, <sup>13</sup>C sensitivity for 1.6mm
- Hexamethylbenzene - <sup>13</sup>C sensitivity for 3.2mm and larger
- Sodiumhexafluorophosphate - <sup>31</sup>P, <sup>19</sup>F pw90
- Silicone Powder - <sup>1</sup>H shimming (much faster)
- D<sub>2</sub>O - <sup>2</sup>H pw90

## Low loss PCS or FTS VT adapter

- Adapts PCS or FTS trunk to a PhoenixNMR probe
- Adapts to Varian/Agilent solids VT stack
- Minimal loss between outlet and probe input (-125 to +100C)

